

Soils Map

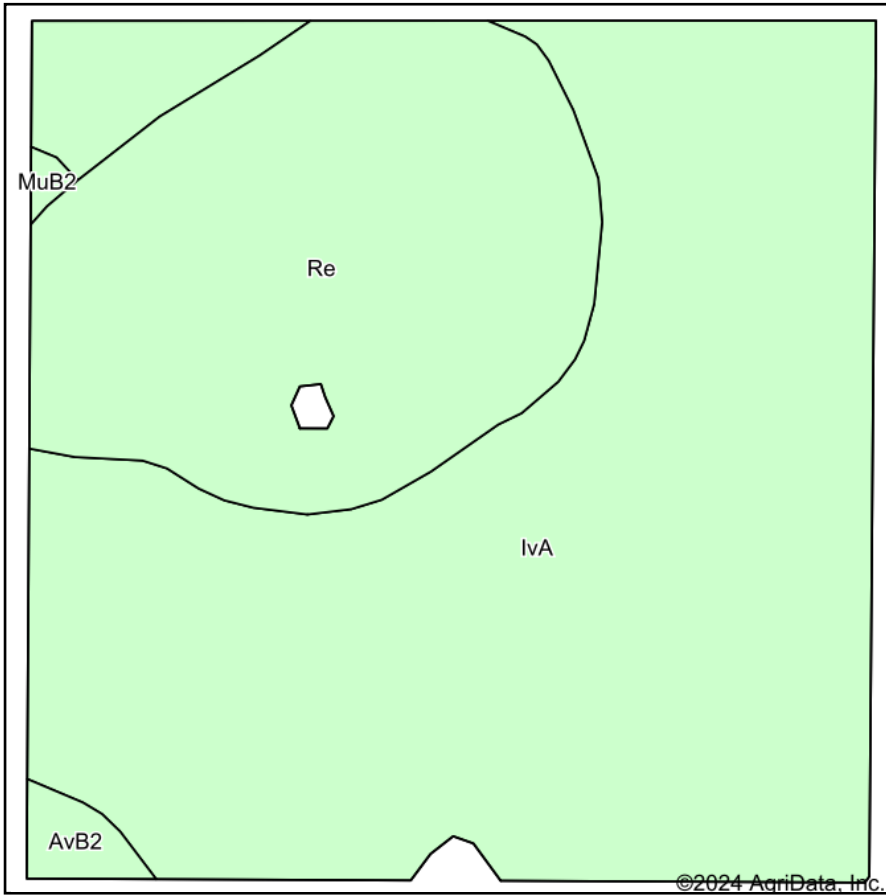

Soils data provided by USDA and NRCS.

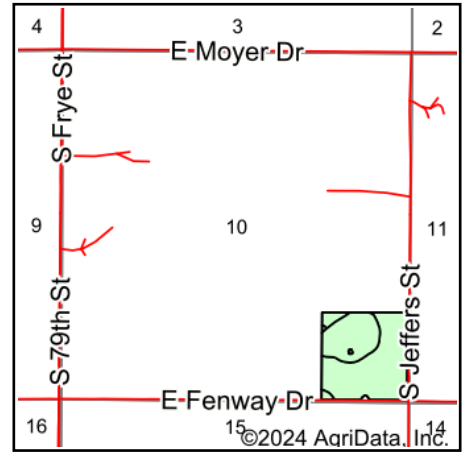

State: **Indiana**
 County: **Vigo**
 Location: **10-11N-8W**
 Township: **Riley**
 Acres: **39.04**
 Date: **4/8/2024**



Area Symbol: IN167, Soil Area Version: 28

Code	Soil Description	Acres	Percent of field	Non-Irr Class *c	Alfalfa hay Tons	Corn Bu	Grass legume hay Tons	Grass legume pasture AUM	Pasture AUM	Soybeans Bu	Winter wheat Bu	*n NCCPI Soybeans
IvA	Iva silt loam, 0 to 2 percent slopes	26.72	68.4%	Ilw		164	5		11	54	73	87
Re	Reesville silt loam, 0 to 2 percent slopes	11.78	30.2%	Ilw		137	4	7		44	53	80
AvB2	Ava silt loam, 2 to 6 percent slopes, eroded	0.44	1.1%	Ile	5	131	4		9	46	59	37
MuB2	Muren silt loam, 2 to 6 percent slopes, eroded	0.10	0.3%	Iw		151	5		10	52	61	79
Weighted Average				2.00	0.1	155.4	4.7	2.1	7.7	50.9	66.8	*n 84.3

*n: The aggregation method is "Weighted Average using all components"

*c: Using Capabilities Class Dominant Condition Aggregation Method

Soils data provided by USDA and NRCS.